

POINT A  
703891.06mN  
300135.93mE  
RL 3.52m

POINT B  
703851.02mN  
300563.93mE  
RL 3.52m

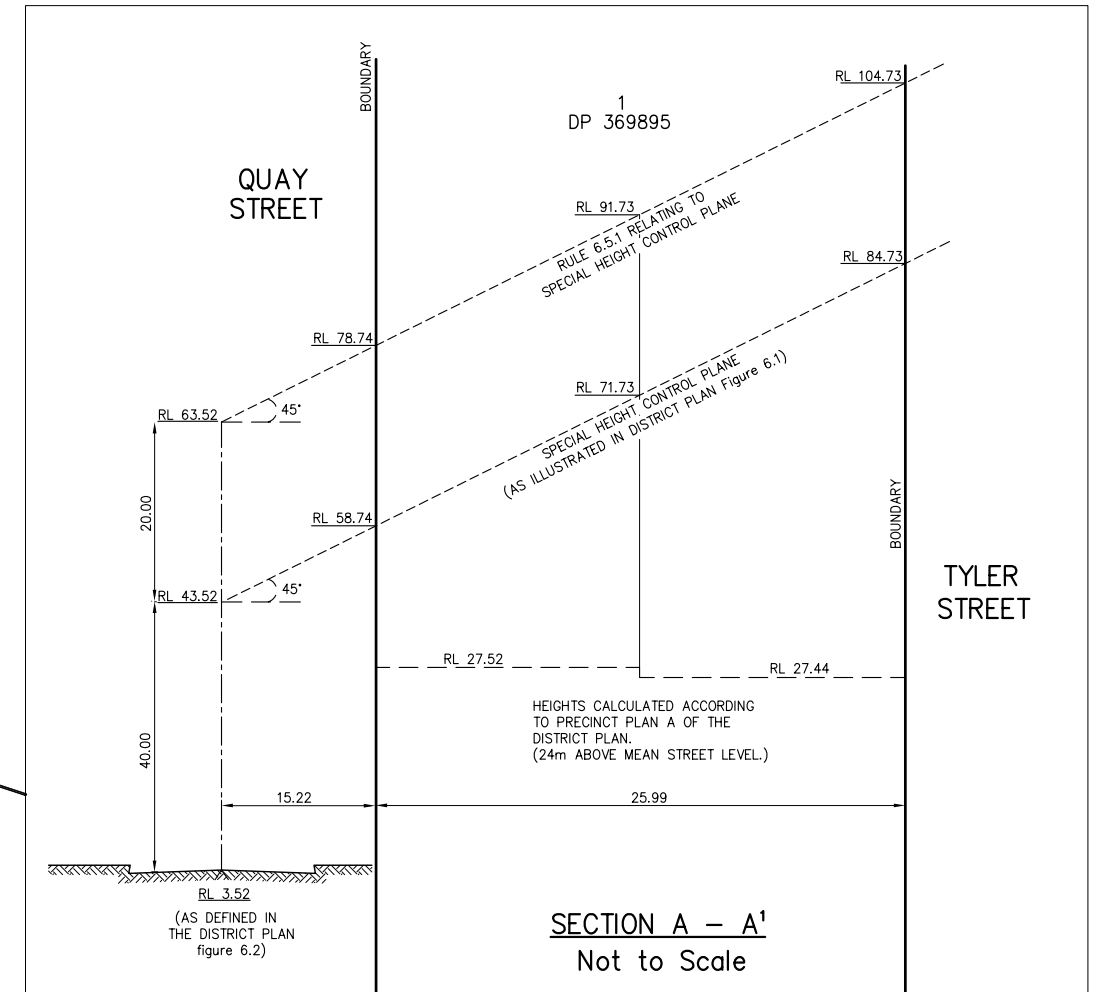
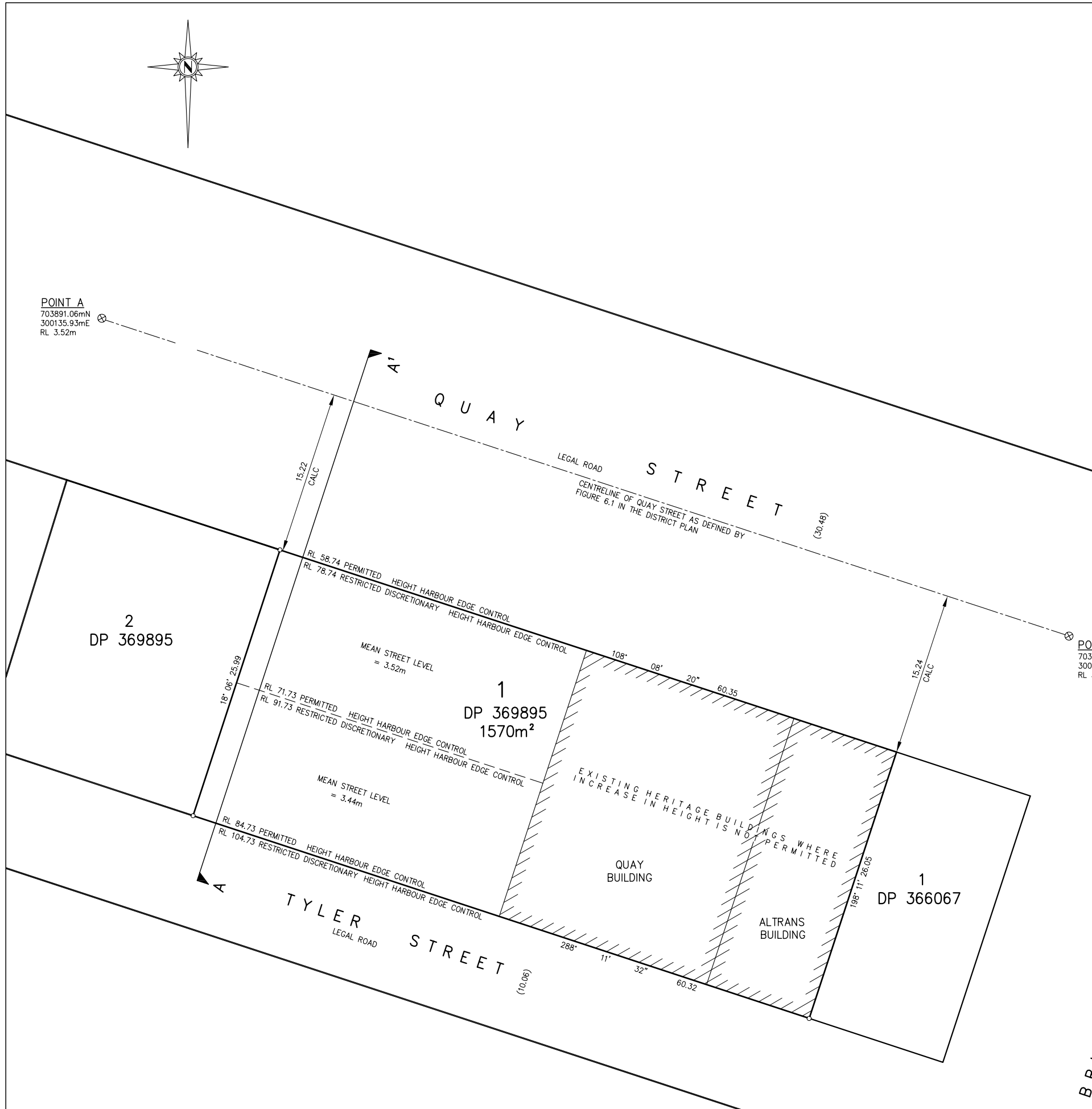

- NOTES:**
- \* LEVELS ARE IN TERMS OF AUCKLAND DATUM 1946 (MEAN SEA LEVEL)
  - \* COORDINATES ARE IN TERMS OF GEODETIC DATUM 1949.
  - \* "DISTRICT PLAN" REFERS TO AUCKLAND CITY COUNCIL DISTRICT PLAN - CENTRAL AREA SECTION- OPERATIVE 2004.
  - \* SECTION A-A' HAS BEEN DEFINED TOWARDS THE WESTERN EXTENT OF THE SITE TO ILLUSTRATE THE WORST CASE MAXIMUM HEIGHT SITUATION.
  - \* BOUNDARY DIMENSIONS ARE FROM DP 369895.
  - \* POINT A & POINT B HAVE BEEN TAKEN FROM FIGURE 6.2 OF THE DISTRICT PLAN.
  - \* THE BRITOMART PRECINCT MAXIMUM HEIGHT FOR SEAFARERS SITE IS 24m ABOVE MEAN STREET LEVEL

DESIGNED:	DATE:	SIGNATURE:	PLOT DATE:	16.04.2008
DRAWN:	DATE:	SIGNATURE:	CAD REF:	16686-SS13.DWG
CHECKED:	DATE:	SIGNATURE:	CAD XREF:	
APPROVED:	DATE:	SIGNATURE:	SURVEY BY:	DGM
			SURVEY DATE:	12/07
REV	AMENDMENT	BY	DATE	SDR REF:

ASSOCIATION OF CONSULTING ENGINEERS NEW ZEALAND

ISO 9001 QUALITY ASSURED

**HARRISON GRIERSON**

CONSULTING ENGINEERS SURVEYORS PLANNERS

71 Great South Road Auckland Ph 09 917 5000 Fax 09 917 5001

PROJECT:

**BRITOMART SEAFARERS COMPANY  
BRITOMART PRECINCT  
AUCKLAND CENTRAL**

TITLE:

**PLAN SHOWING  
MAXIMUM HEIGHT RESTRICTIONS**

PLOT STATUS:	
HG REF: 1030.16686.20	SCALES: 1:200 1:400 @ A3
DRAWING No: <b>16686-SS13</b>	A1 REV