

AUCKLAND CITY OPERATIVE DISTRICT PLAN
(Hauraki Gulf Islands Section)

Proposed Plan Change under Section 73 of the
Resource Management Act 1991

PROPOSED PLAN CHANGE: PLAN MODIFICATION No. 30

Amendment to Planning Map No.1 Sheet No. 1

The land shown  to be classified Land Unit 17 (Landscape Amenity)
Access Reserve, Lot 58, D.P. 69718

Date of Council Resolution: 20 April 2001

Date of Public Notification: 8 July 2001

Closing Date for Submission: 10 August 2001

File No. 311/229030

Scale: 1: 4000

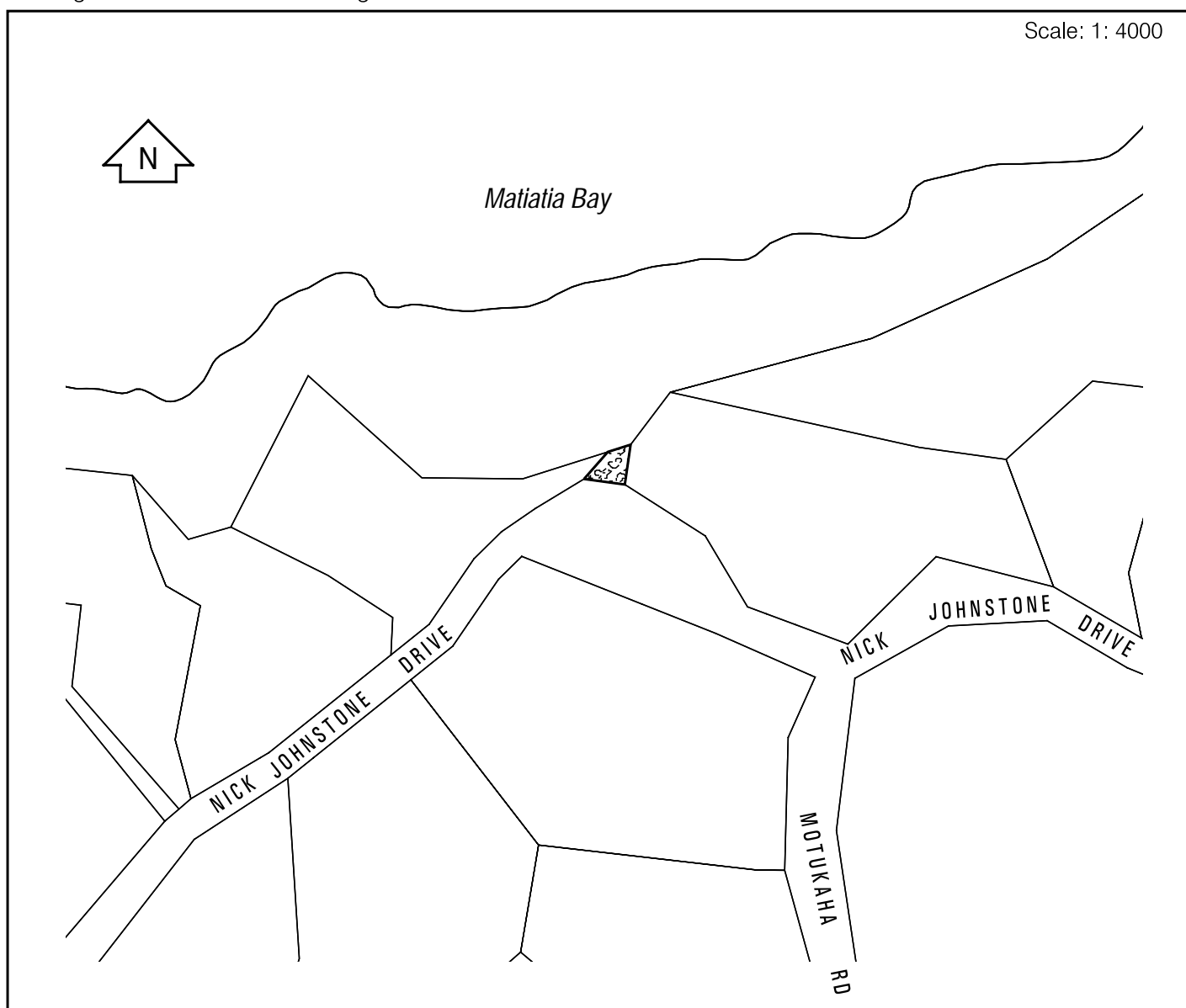

AUCKLAND CITY OPERATIVE DISTRICT PLAN
(Hauraki Gulf Islands Section)

Proposed Plan Change under Section 73 of the
 Resource Management Act 1991

PROPOSED PLAN CHANGE: PLAN MODIFICATION No. 30

Amendment to Planning Map No. 1 Sheet No. 3

The land shown  to be classified Land Unit 17 (Landscape Amenity)
 Esplanade Reserve, Lot 3 D.P. 175402

File No. 311/229030

Scale: 1: 4000

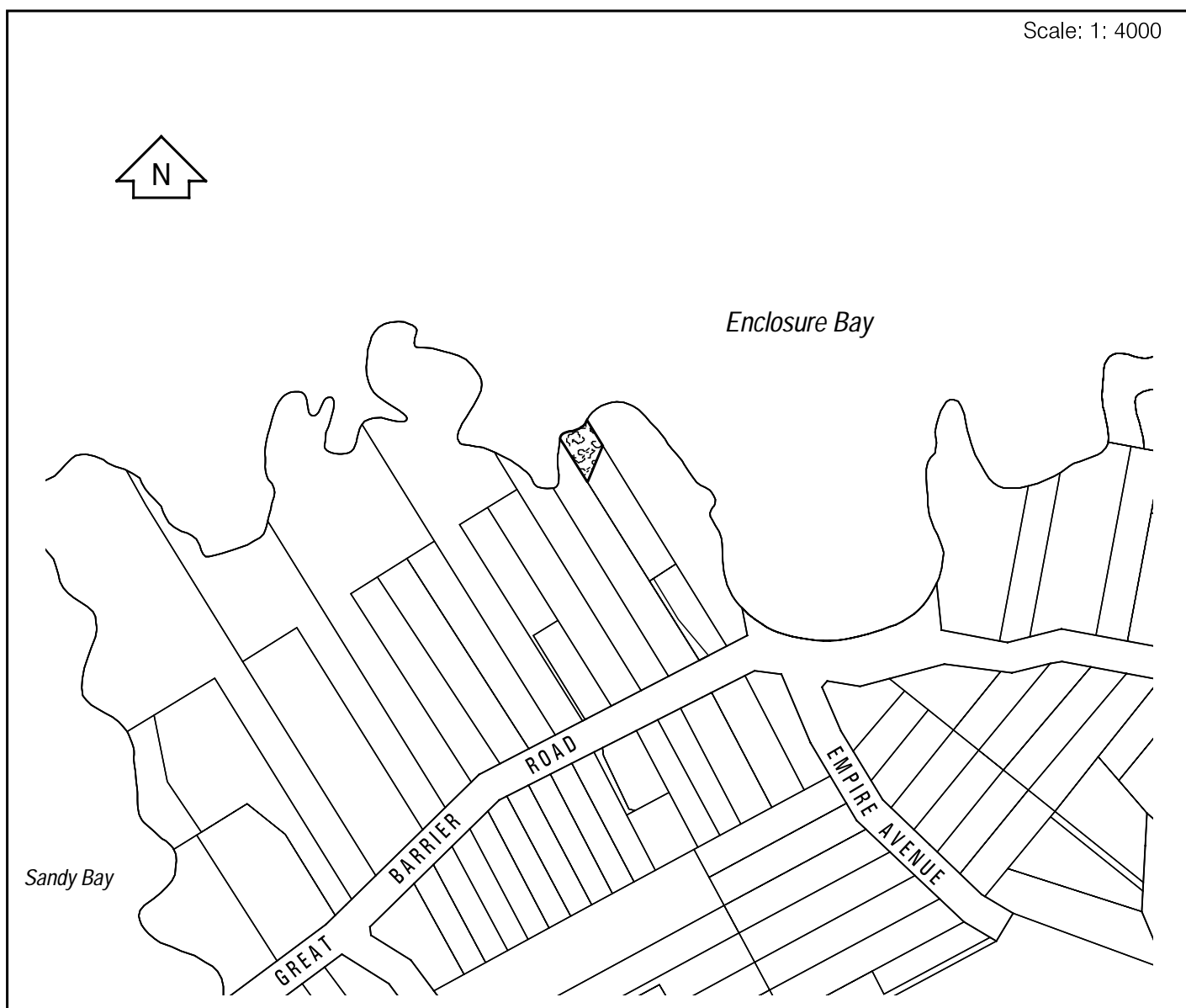

AUCKLAND CITY OPERATIVE DISTRICT PLAN
(Hauraki Gulf Islands Section)

Proposed Plan Change under Section 73 of the
 Resource Management Act 1991

PROPOSED PLAN CHANGE: PLAN MODIFICATION No. 30

Amendment to Planning Map No. 1 Sheet No. 3

The land shown  to be classified Land Unit 11 (Traditional Residential)
 51, 53, 55 Junction Road

File No. 311/229030

Scale: 1: 4000



AUCKLAND CITY OPERATIVE DISTRICT PLAN
(Hauraki Gulf Islands Section)

Proposed Plan Change under Section 73 of the
 Resource Management Act 1991

PROPOSED PLAN CHANGE: PLAN MODIFICATION No. 30

Amendment to Planning Map No. 1 Sheet No. 3

The land shown  to be classified Land Unit 17 (Landscape Amenity)
 Plantation Reserve, Lot 446, D.P. 16816

File No. 311/229030

Scale: 1 : 3,000

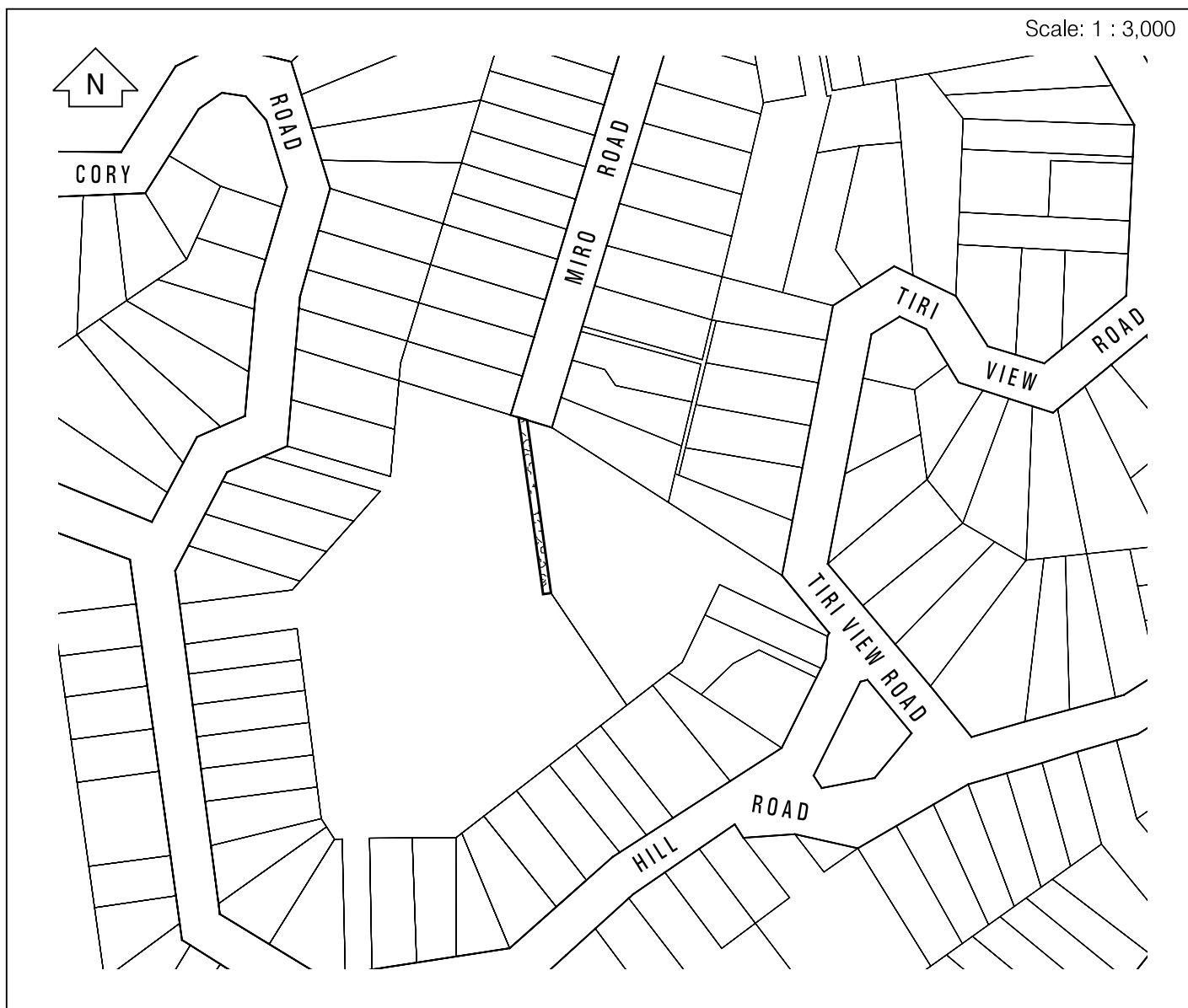

AUCKLAND CITY OPERATIVE DISTRICT PLAN
(Hauraki Gulf Islands Section)

Proposed Plan Change under Section 73 of the
 Resource Management Act 1991

PROPOSED PLAN CHANGE: PLAN MODIFICATION No. 30

Amendment to Planning Map No. 1 Sheet No. 3 & 4

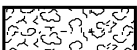
The land shown  to be classified Land Unit 17 (Landscape Amenity)
 Esplanade reserve, Lot 8, D.P. 193750 Huruhi Bay

File No. 311/229030

Scale: 1:6000



AUCKLAND CITY OPERATIVE DISTRICT PLAN
(Hauraki Gulf Islands Section)

Proposed Plan Change under Section 73 of the
 Resource Management Act 1991

PROPOSED PLAN CHANGE: PLAN MODIFICATION No. 30

Amendment to Planning Map No.1 Sheet No. 4

The land shown  to be classified Unit 12 (Bush Residential) 49 Burrell Road

File No. 311/229030

Scale: 1: 4000

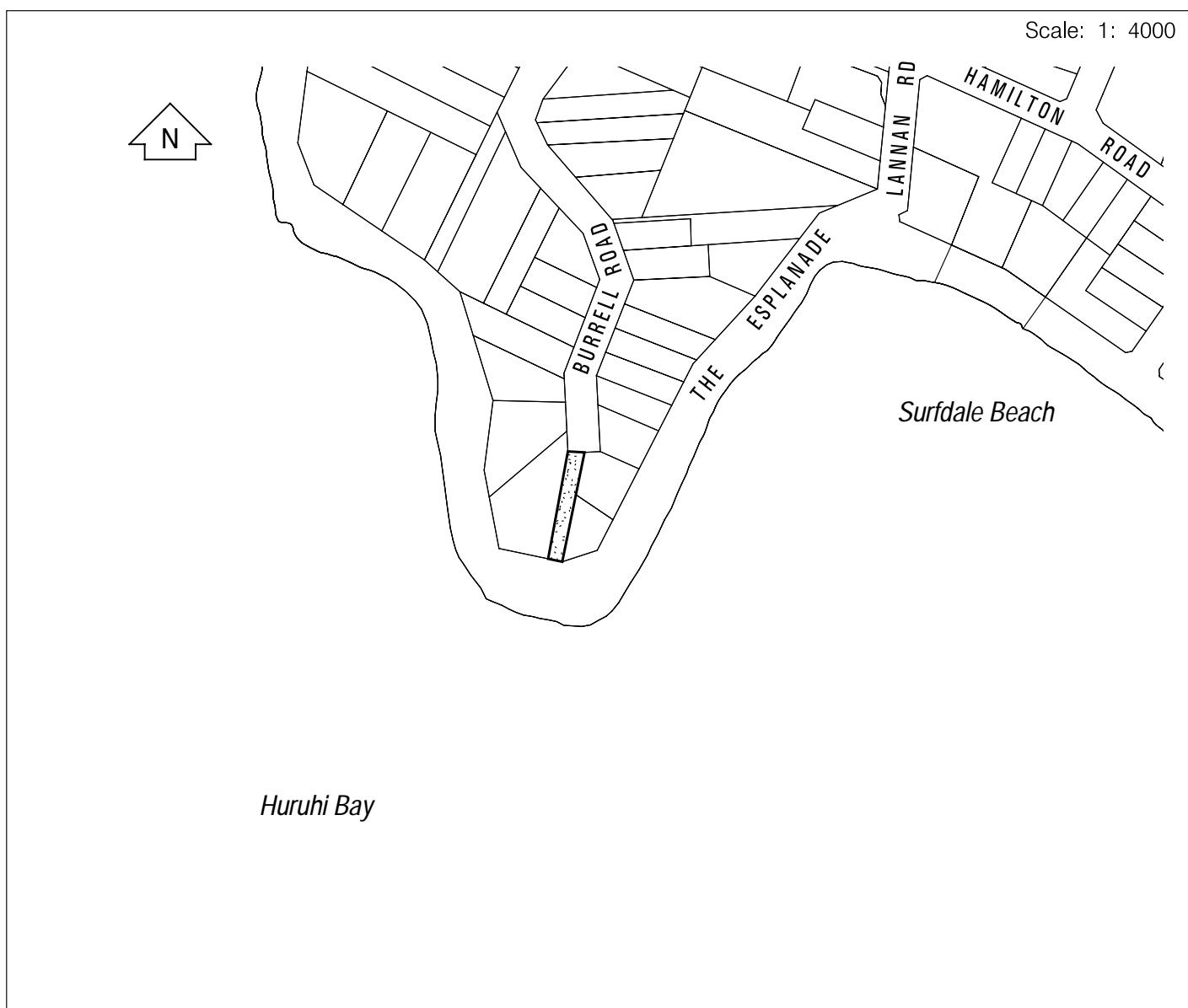

AUCKLAND CITY OPERATIVE DISTRICT PLAN
(Hauraki Gulf Islands Section)

Proposed Plan Change under Section 73 of the
 Resource Management Act 1991

PROPOSED PLAN CHANGE: PLAN MODIFICATION No. 30

Amendment to Planning Map No. Sheet No. 4

The land shown  to be classified Land Unit 17 (Landscape Amenity)
 Plantation Reserve, Shelly Beach Road

File No. 311/229030

Scale: 1: 4000

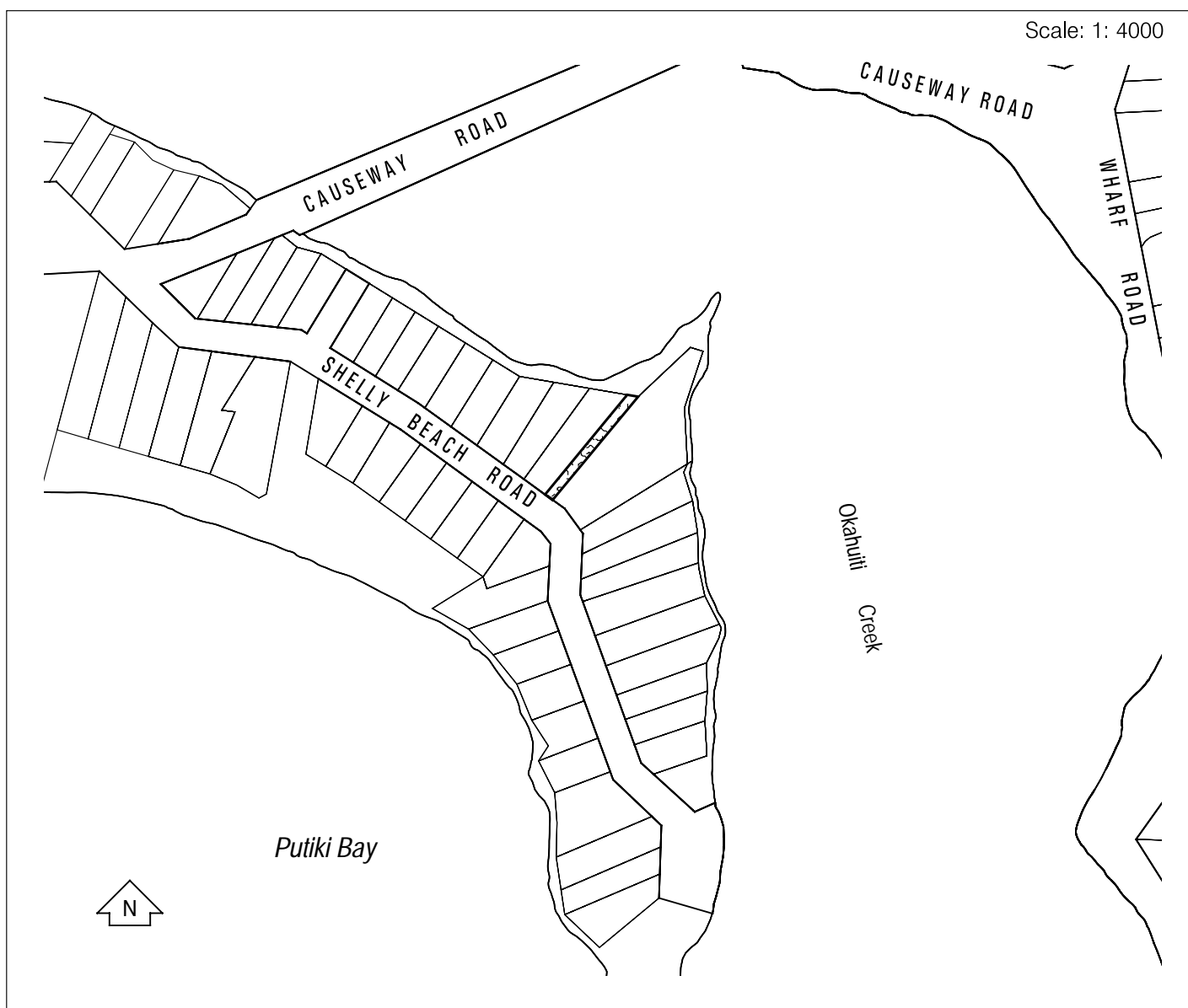

AUCKLAND CITY OPERATIVE DISTRICT PLAN
(Hauraki Gulf Islands Section)

Proposed Plan Change under Section 73 of the
 Resource Management Act 1991

PROPOSED PLAN CHANGE: PLAN MODIFICATION No. 30

Amendment to Planning Map No. 1 Sheet No. 7

The land shown 

to be classified Land Unit 17 (Landscape Amenity)
 Esplanade Reserves, Lot 4 DP 201403, Lot 6 DP 173104

File No. 311/229030

Scale: 1: 4000



AUCKLAND CITY OPERATIVE DISTRICT PLAN
(Hauraki Gulf Islands Section)

Proposed Plan Change under Section 73 of the
 Resource Management Act 1991

PROPOSED PLAN CHANGE: PLAN MODIFICATION No. 30

Amendment to Planning Map No. Sheet No. 7

The land shown

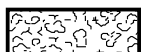

to be classified Land Unit 17 (Landscape Amenity) Lot 4, D.P.168995
 Esplanade Reserves, Lot 3 DP182519, Lot 3 DP170479, Sea View Road

File No. 311/229030

Scale: 1: 4000

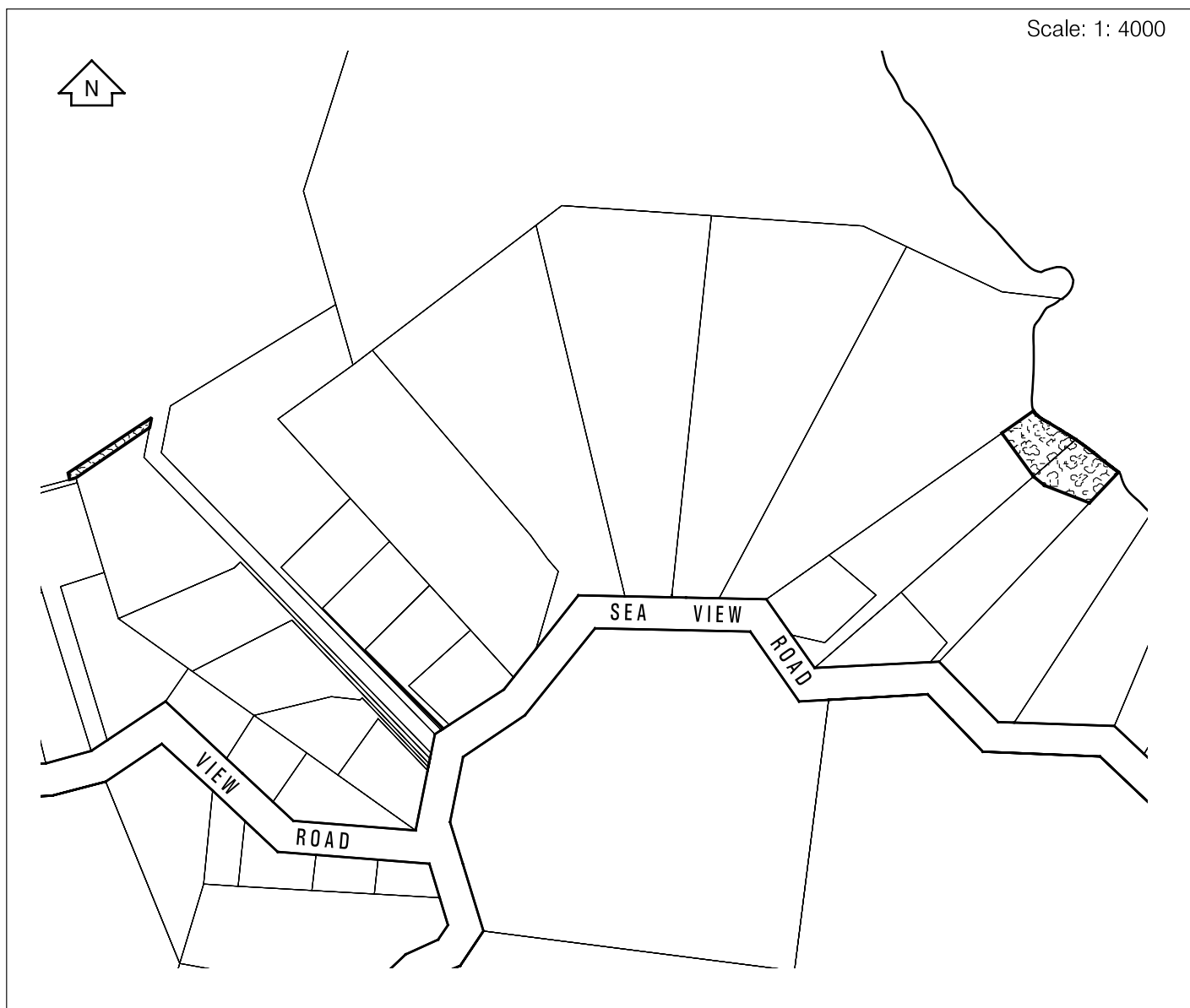

AUCKLAND CITY OPERATIVE DISTRICT PLAN
(Hauraki Gulf Islands Section)

Proposed Plan Change under Section 73 of the
 Resource Management Act 1991

PROPOSED PLAN CHANGE: PLAN MODIFICATION No. 30

Amendment to Planning Map No. 8

The land shown  to be classified Land Unit 17 (Landscape Amenity) Accessway, Lot 1, DP 55601

File No. 311/229030

Scale: 1 : 2,000



AUCKLAND CITY OPERATIVE DISTRICT PLAN
(Hauraki Gulf Islands Section)

Proposed Plan Change under Section 73 of the
 Resource Management Act 1991

PROPOSED PLAN CHANGE: PLAN MODIFICATION No. 30

Amendment to Planning Map No. 8

The land shown  to be classified Land Unit 17 (Landscape Amenity)
 Access Reserves, Lots 17, 18, 19, DP 184090.

File No. 311/229030

Scale: 1 : 5,500

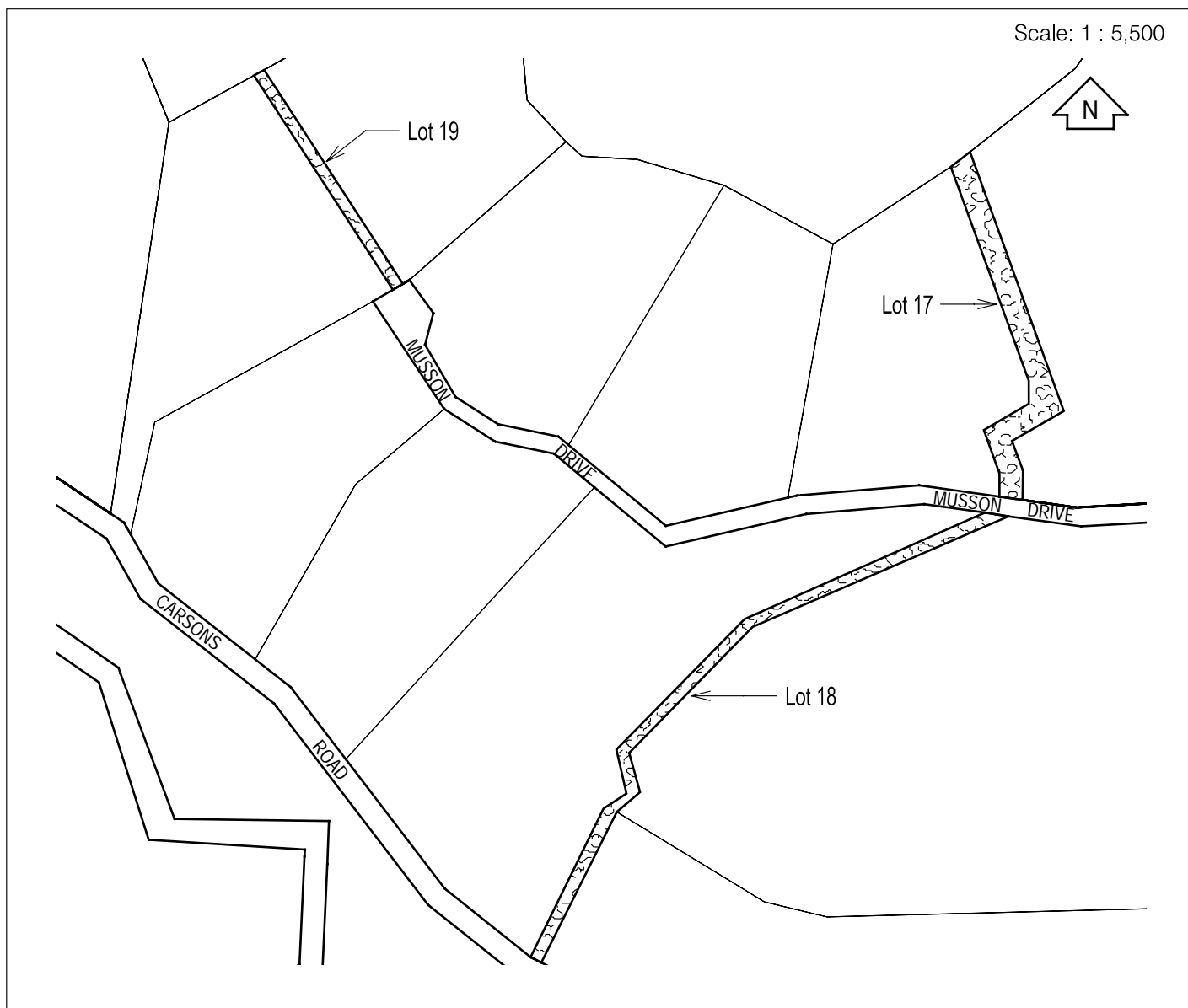

AUCKLAND CITY OPERATIVE DISTRICT PLAN
(Hauraki Gulf Islands Section)

Proposed Plan Change under Section 73 of the
Resource Management Act 1991

PROPOSED PLAN CHANGE: PLAN MODIFICATION No. 30

Amendment to Planning Map No. 9

The land shown  to be classified Land Unit 17 (Landscape Amenity)
Esplanade Reserve, Lot 11, DP 186680.

File No. 311/229030

Scale: 1 : 5,000

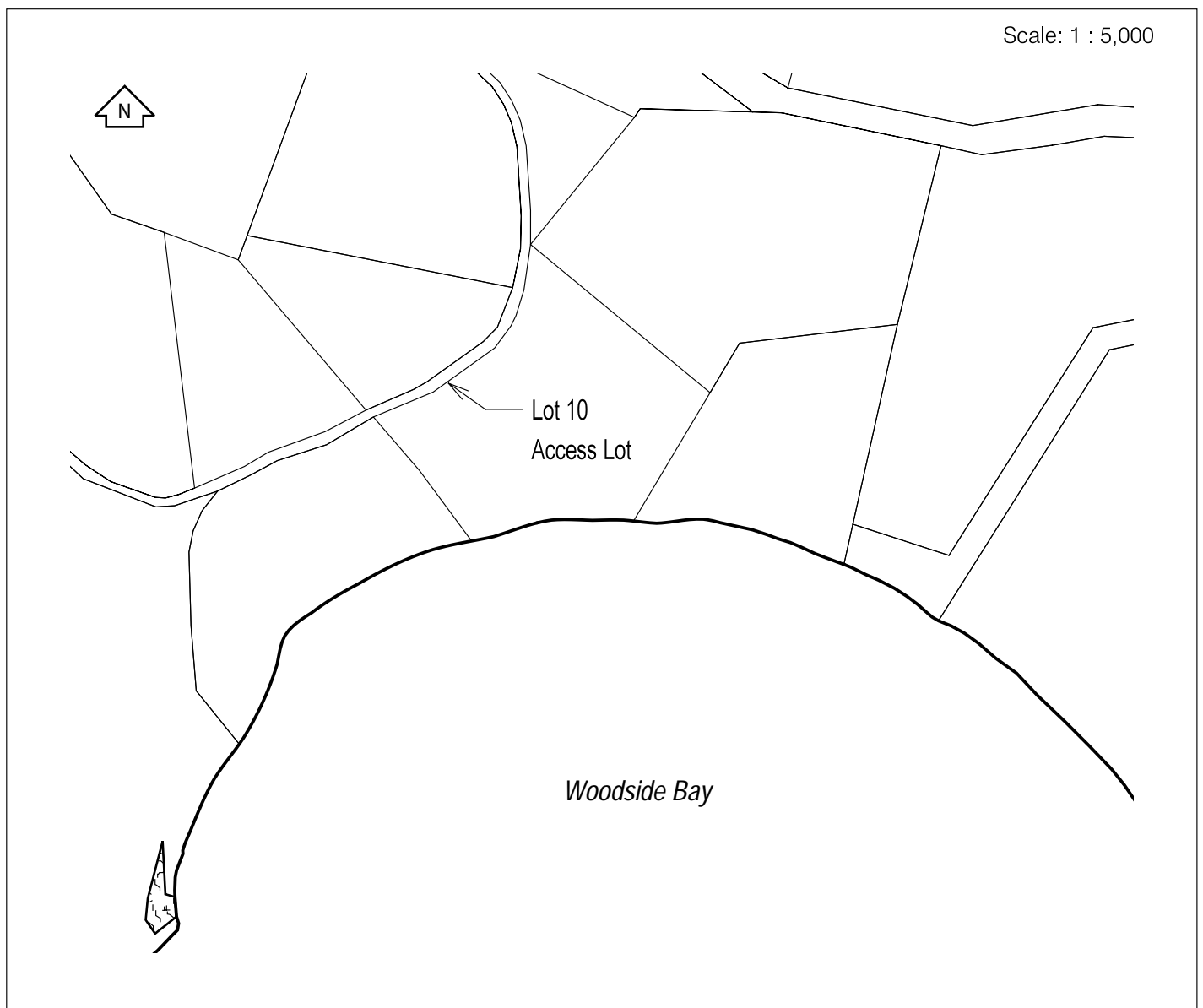

AUCKLAND CITY OPERATIVE DISTRICT PLAN
(Hauraki Gulf Islands Section)

Proposed Plan Change under Section 73 of the
 Resource Management Act 1991

PROPOSED PLAN CHANGE: PLAN MODIFICATION No. 30

Amendment to Planning Map No. 12

The land shown  to be classified Land Unit 17 (Landscape Amenity)
 Esplanade Reserve, Lot 5, 7, 8, DP 165463.

File No. 311/229030

Scale: 1 : 5,000

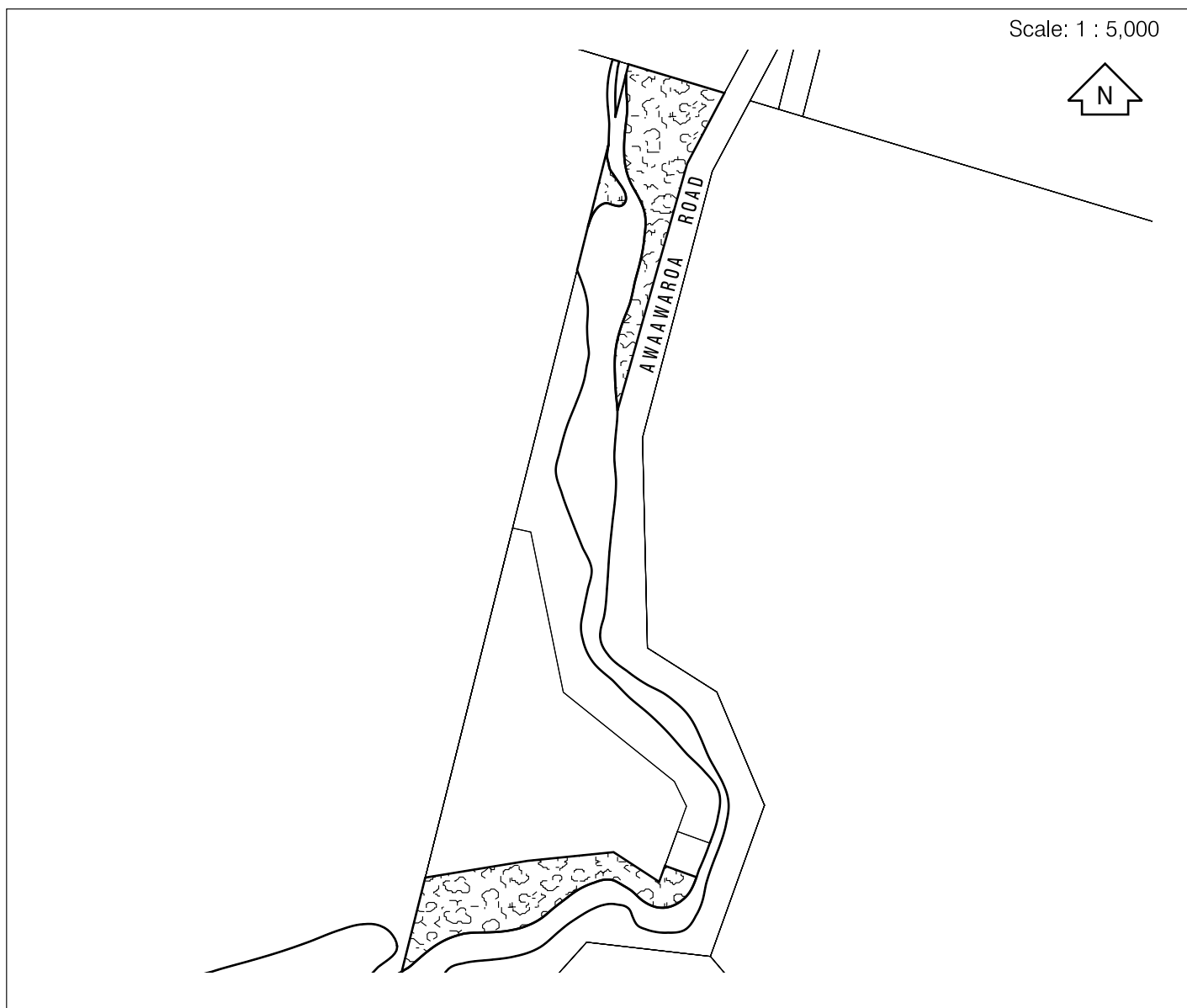

AUCKLAND CITY OPERATIVE DISTRICT PLAN
(Hauraki Gulf Islands Section)

Proposed Plan Change under Section 73 of the
 Resource Management Act 1991

PROPOSED PLAN CHANGE: PLAN MODIFICATION No. 30

Amendment to Planning Map No. 17

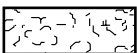
The land shown  to be classified Land Unit 17 (Landscape Amenity)
 Te Matuku Bay Esplanade Reserve.

File No. 311/229030

Scale: 1 : 5,000

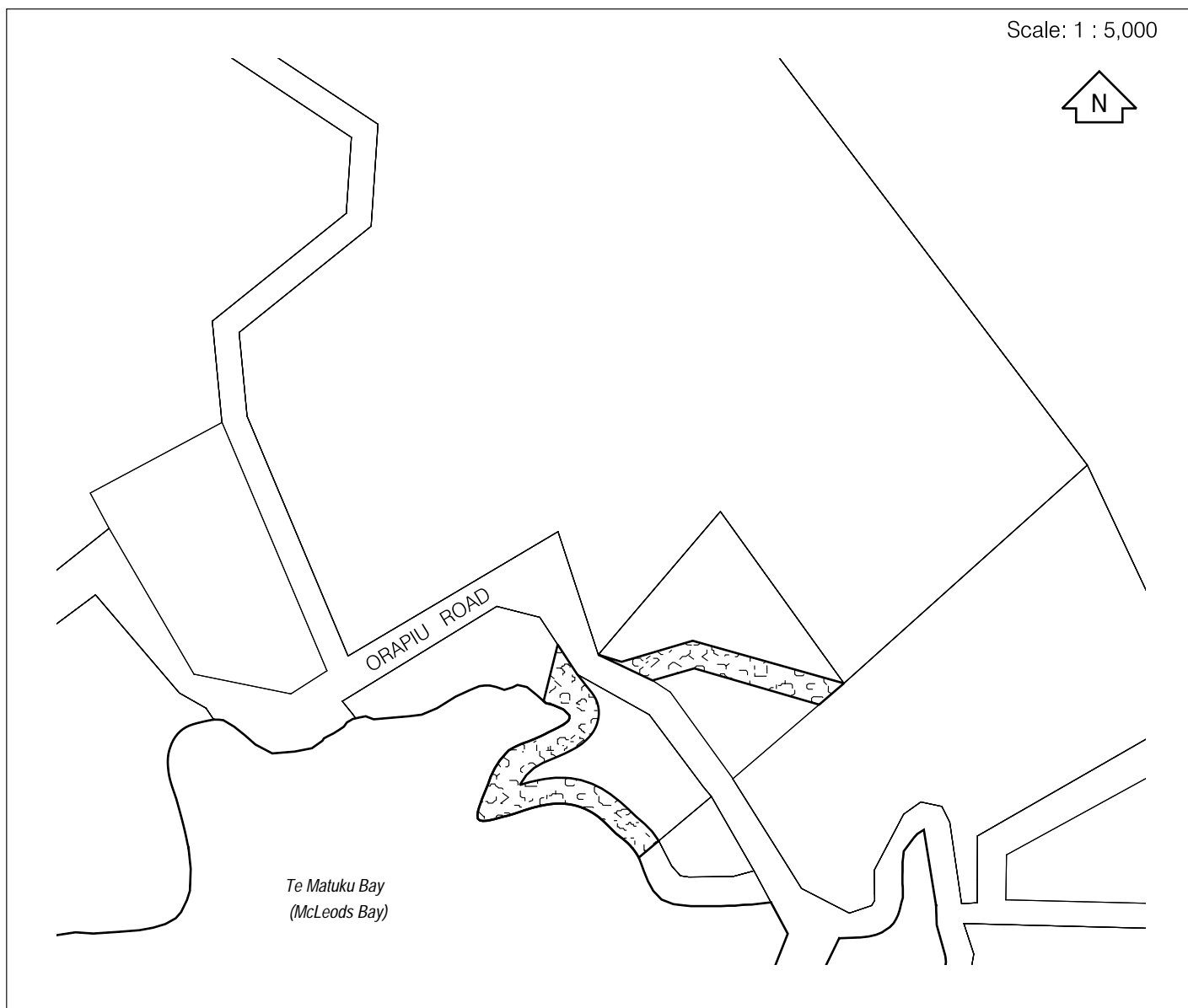

AUCKLAND CITY OPERATIVE DISTRICT PLAN

(Hauraki Gulf Islands Section)

Proposed Plan Change under Section 73 of the
Resource Management Act 1991

PROPOSED PLAN CHANGE: PLAN MODIFICATION No. 30

Amendment to Planning Map No. 18

The land shown  to be classified Land Unit 17 (Landscape Amenity)
Bush Reserves, DP 11620.

File No. 311/229030

Scale: 1 : 3,000

