

Notice of Removal of Designation Under Section 182 of the Resource
Management Act 1991

- To: Auckland City Council
City Planning
Private Bag 92 516
Wellesley Street
Auckland
Attention: Joao Machado, Manager - City Planning
- And to: Office of Treaty Settlements
PO Box 180
Wellington 6011
Attention: David Stevenson
- And to: WN Donovan
19 Waikare Road
Waiheke Island
- And to: G P Newlove, A J G Elton and M B D Cooney
25 Waikare Road
Waiheke Island
- And to: G P Clatworthy and E C Tipping-Clatworthy
48 Beach Parade
Waiheke Island
- And to: P J McIntyre, P J McIntyre and W L Butterworth
46 Beach Parade
Waiheke Island
- And to: C J Sciascia, B G Sciascia and M J Quirk
44 Beach Parade
Waiheke Island

From: New Zealand Police
C/o Beca Planning
P O Box 6345
Auckland
Attention: Jacky Bartley, Senior Planner

The Minister of Police gives notice to the Auckland City Council that it no longer requires the following designation:

- The original police station location is shown as a designation for police purposes in the Auckland City District Plan - Hauraki Gulf Islands Section Operative 1996. The designation is scheduled in Appendix G and shown on Map 3a, Reference A.
- The original police station on Waiheke Island is located at 21-23 Waikare Road, Oneroa. The designation relates to the site that is legally described as the parcels of land being Lots 20 and 21, Deposited Plan 22848 (CT 623/154). The site occupies an area of 1707 square metres.

The New Zealand Police, as requiring authority, requests the Auckland City Council to amend the Auckland City District Plan - Hauraki Gulf Islands Section Operative 1996 accordingly with the removal of this designation in full, as required by section 182 of the Resource Management Act 1991.

Signature on behalf of Minister of Police



.....

Name/Position: *A. MACARTHUR - NATIONAL PROPERTY*

Date: *15.7.10*

Address for Service for Requiring Authority:

New Zealand Police

C/o Beca Planning

P O Box 6345

Auckland

Phone: 09 336 5949

Fax: 09 300 3000

Email: jacky.bartley@beca.com

Contact Person: Jacky Bartley, Senior Planner

Notice of Withdrawal of Requirement Under Section 168(4) of the
Resource Management Act 1991

To: Auckland City Council
City Planning
Private Bag 92 516
Wellesley Street
Auckland
Attention: Joao Machado, Manager – City Planning

From: New Zealand Police
C/o Beca Planning
P O Box 6345
Auckland
Attention: Jacky Bartley, Senior Planner

The Minister of Police gives notice to the Auckland City Council that it no longer requires the following designation:

- The original police station location is shown as a designation for police purposes in the Proposed Auckland City District Plan – Hauraki Gulf Islands Section, 2006. The designation is scheduled in Appendix 7 and shown on Map 2, Planning Map Ref 2-9. The New Zealand Police would like the removal of this designation from the Proposed Plan.
- The original police station on Waiheke Island is located at 21-23 Waikare Road, Oneroa. The designation relates to the site that is legally described as the parcels of land being Lots 20 and 21, Deposited Plan 22848 (CT 623/154). The site occupies an area of 1707 square metres.

The New Zealand Police, as requiring authority, requests the Auckland City Council to amend the Auckland City District Plan – Hauraki Gulf Islands Section Proposed 2006 accordingly with the withdrawal of this requirement in full, as set out in the First Schedule, Part 4, Clause 10 of the Resource Management Act 1991.

Signature on behalf of Minister of Police



Name/Position: *A. MARGULIES - NATIONAL PROPERTIES
MANAGER*

Date: *15.7.10*

Address for Service for Requiring Authority:

New Zealand Police

C/o Beca Planning

P O Box 6345

Auckland

Phone: 09 336 5949

Fax: 09 300 3000

Email: jacky.bartley@beca.com

Contact Person: Jacky Bartley, Senior Planner

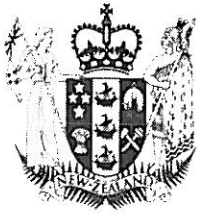

COMPUTER FREEHOLD REGISTER UNDER LAND TRANSFER ACT 1952

Search Copy



R W Muir
Registrar-General
of Land

Identifier **NA105D/665**
Land Registration District **North Auckland**
Date Issued 10 February 1997

Prior References
PROC 9735

Estate	Fee Simple
Area	1707 square metres more or less
Legal Description	Lot 120-121 Deposited Plan 22848
Purpose	Police station

Proprietors
Her Majesty the Queen

Interests

10 1000

AUCKLAND CITY

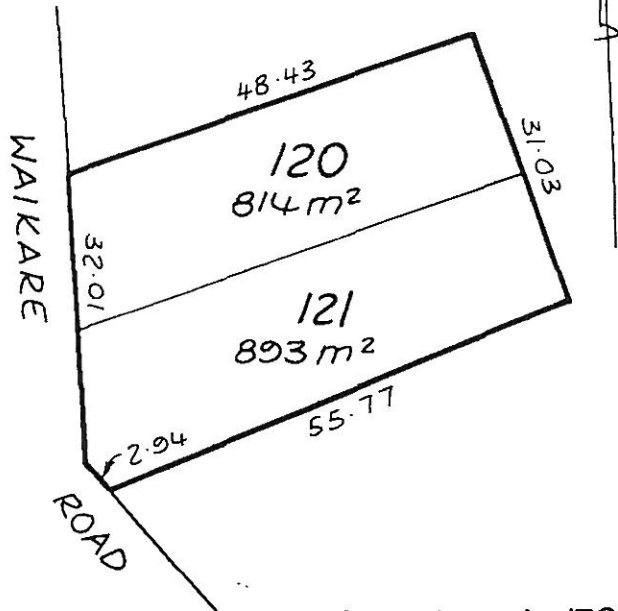

Caleb Sutton

From: Jacky Bartley [Jacky.Bartley@beca.com]
Sent: Wednesday, 28 July 2010 11:16
To: Caleb Sutton
Subject: FW: CTs for 21-23 Waikare Road
Attachments: SKMBT_75010072807230.pdf; SKMBT_75010072807280.pdf

Hi Caleb

Thanks for your phone call regarding the CTs for the above site.

Please find attached a copy of the historic CT for the sites at 21-23 Waikare Road, the first one is the original CT for the site which is referenced on the notices I have provided (Lots 20 & 21 DP 22848 (CT 623/154)), this has since been cancelled in part and replaced with the latest CT (NA105D/665 - Lot 120-121 DP 22848), which is the one that accompanied the application.

Please let me know if you would like me to update the Notices I have given you to reflect this or whether the information provided is sufficient.

Kind regards

Jacky Bartley (nee Rua)

Senior Planner
Beca
Phone +64 9 300 9000 Fax +64 9 300 9300
DDI +64 9 336 5949
Mobile: 027 215 8324
jacky.bartley@beca.com
www.beca.com

Lots 20 & 21 DP 22848 (CT 623/154)

NA105D/665 - Lot 120-121 DP 22848

NOTICE: This email, if it relates to a specific contract, is sent on behalf of the Beca company which entered into the contract. Please contact the sender if you are unsure of the contracting Beca company or visit our web page <http://www.beca.com> for further information on the Beca Group. If this email relates to a specific contract, by responding you agree that, regardless of its terms, this email and the response by you will be a valid communication for the purposes of that contract, and may bind the parties accordingly.

This e-mail together with any attachments is confidential, may be subject to legal privilege and may contain proprietary information, including information protected by copyright. If you are not the intended recipient, please do not copy, use or disclose this e-mail; please notify us immediately by return e-mail and then delete this e-mail.

29/07/10